



CLEANING MANAGEMENT SYSTEM

#3 Non-Acid Disinfectant Detergent is designed to be used with the Cleanworks® Cleaning Management System. The system dispenses precisely diluted disinfectant detergent with the touch of a button...ready to work in spray, wipe-on, or mop-on applications. Highly concentrated formula saves storage space and helps reduce disposal costs. Cleanworks® is simple, accurate and user friendly.

The cleanworks® Cleaning Management System is subject of U.S. Patents No. 5037003, 5083677, & 5228598

1.800.527.5722
www.cleanworks.net

3 NON-ACID DISINFECTANT DETERGENT

Why it's a better cleaner

The Cleanworks® System dispenses it right...every time.

- Non-acid, neutral pH - Can be used on most hard surfaces
- Broad spectrum, hospital use - Effective against a wide range of pathogenic bacteria and viruses (including HBV, HCV and HIV-1)
- Fresh, deodorizing scent - Counteracts airborne odors
- Excellent for use in toilet bowls/urinals - One-step cleaning and disinfection
- Quaternary ammonium based, disinfectant cleaner - Effective in 400 ppm hard water



How it cleans



Dispense precisely diluted cleaner into a clean, empty container. If solution is for reuse, properly label RTU container.

DISINFECTANT/CLEANER/DEODORIZER:



Remove heavy soil deposits from surface. Then thoroughly wet surface with solution applied with a cloth, mop, sponge, coarse spray, or soaking.



Let solution remain on surface for a minimum of 10 minutes. Allow to air dry. Prepare a fresh solution daily or more often if the solution becomes visibly dirty or diluted.

TOILET BOWL DISINFECTANT:



Force water from bowl. Pour in 3 oz. of the diluted solution. Swab the bowl completely using a scrub brush or mop, making sure to get under rim.

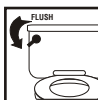

Let stand for 10 minutes or overnight, then flush.



Dispense 1,285 quarts or 321 gallons of ready-to-use disinfectant cleaner from the 1.25 gallon concentrate of Cleanworks® #3 Non-Acid Disinfectant Detergent.

Where it cleans

- Hard, nonporous surfaces
- Floors, walls
- Metal surfaces (non medical)
- Stainless steel surfaces (non medical)
- Glazed porcelain
- Plastic surfaces
- Toilet bowls
- Showers
- Tabletops
- Veterinary practice

Technical Data

Packaging (concentrate) 1.25 Gallon
Concentrate Color Orange
RTU Color Faint Orange
RTU Fragrance Light
Foaming Low
Free-Rinsing Yes
Acid None
% Phosphates None
pH (concentrate) 7.2-8.2
EPA Registered Yes

Efficacy

Pseudomonas aeruginosa, *Staphylococcus aureus*, *Salmonella choleraesuis*, *Escherichia coli*, *Staphylococcus aureus* (MRSA), *Staphylococcus aureus* (VISA), *Streptococcus pyogenes*, *Enterococcus faecalis* (VRE), *Canine distemper*, *Feline leukemia*, *Hepatitis B* (HBV), *Hepatitis C* (HCV), *Herpes simplex type 1 & 2*, *HIV-1* (AIDS virus), *SARS*, *Associated Coronavirus*, *Pseudorabies*, and many more.